

**READ THESE INSTRUCTIONS COMPLETELY BEFORE STARTING WORK.
IF YOU DON'T UNDERSTAND CALL 724-588-8600 FOR ASSISTANCE.**

STABILIZER ACCESSORY KIT

**KIT TO BE USED ON
WERNER CO. SINGLE SECTION,
EXTENSION, TELESCOPING AND
FOLDING MULTI PURPOSE LADDERS**



WARNING:

1. Failure to comply with all instructions may result in serious injury.
2. Make sure this kit fits your ladder. Refer to the outside of the kit's packaging.
If you have any questions concerning the use of this kit on other Werner Co. products, call 724-588-8600 for assistance.
3. Before installing this kit, identify all kit components. If any components are missing or damaged, return the kit to place of purchase. Do not substitute any components.
4. Inspect the ladder before installing this kit. Repair or replace any damaged or missing ladder parts before using the ladder. Use only with Werner Co. repair or replacement parts. If unable to repair, discard the ladder.

COMPONENTS IN KIT

(1) STABILIZER

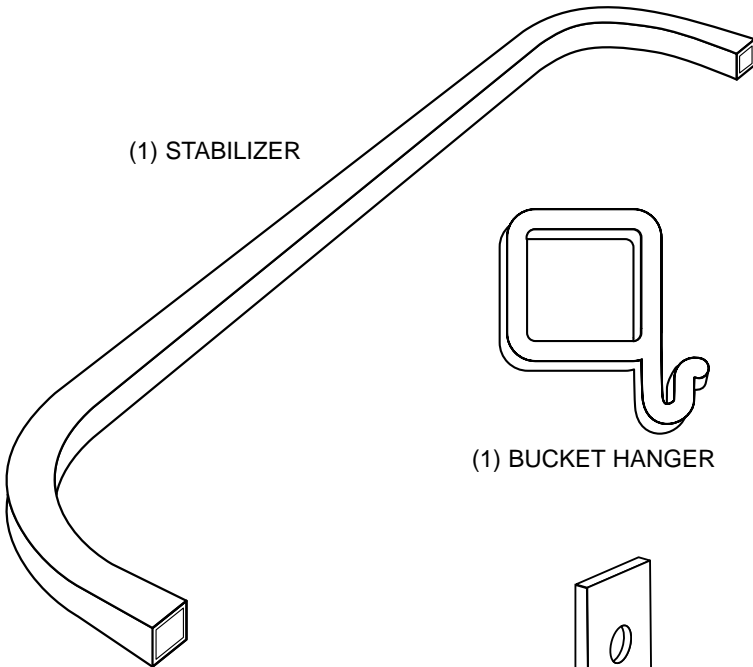

(2) TUBING CAPS

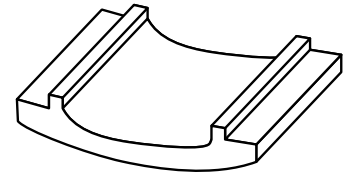

(1) BUCKET HANGER

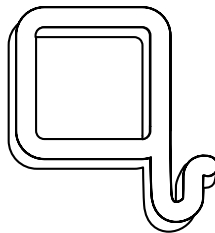

(2) MOLDED CAPS

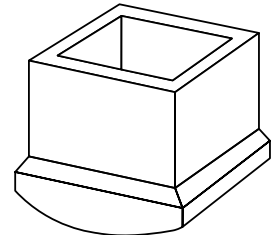

(2) PLATES

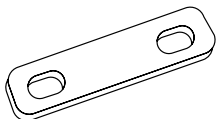

(4) WING NUTS



(2) NARROW
ANGLE CLIPS

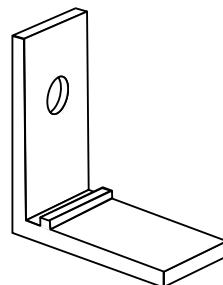

(2) U-BOLTS

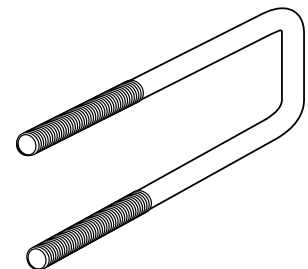

INSPECTION

1. Inspect for damaged or missing parts before each use.
2. Never use a stabilizer with missing or damaged parts.
3. Never repair a damaged stabilizer.
4. Destroy stabilizer if exposed to excessive heat or any corrosive agent.

PROPER SET-UP AND USE:

1. READ ALL LABELS ON STABILIZER AND INSTRUCTIONS WITH LADDER.
2. DANGER! Metal Conducts Electricity! Never use near any electrical current.
3. CHECK THAT STABILIZER IS ASSEMBLED TO LADDER CORRECTLY.
4. DO NOT DROP LADDER OR STABILIZER.
5. Do not stand on or above stabilizer.
6. Do not use stabilizer as a support for planks.
7. Do not use stabilizer or ladder on any slippery surface.
8. You should never use stabilizer or any climbing equipment if you are not in good physical condition.
9. Stabilizer is designed to support the weight of one person and material (300 Lb. Maximum). Check that ladder duty rating is sufficient also.
10. Check that all four ends of ladder and stabilizer are firmly supported to prevent excessive movements.
11. Set ladder at proper angle by placing your toes

against the bottom of the ladder. Stand erect. Extend your arms straight out. When palms of your hands contact the top of the rung, which is about shoulder level, ladder is at approximately the proper angle. (Check with other labels on ladder). Use only at proper angle.

12. Securely ENGAGE LADDER LOCKS BEFORE CLIMBING! Do not rest stabilizer on a surface which fails to allow locks to fully engage.
13. DO NOT OVER-REACH. Always keep belt buckle between side rails when climbing or working from ladder. You may lose your balance and/or tip the ladder.
14. Use extreme caution when pushing or pulling anything while on a ladder. You may lose your balance and/or tip the ladder.
15. Windy conditions require extra caution.
16. Do not use this stabilizer with any components not supplied or approved by WERNER CO.
17. Read and understand all labels on ladder also before use.

PROPER CARE AND STORAGE:

1. Always keep stabilizer clean of all foreign materials.
2. Never store material on stabilizer.

ALWAYS USE STABILIZER AS DESCRIBED ABOVE. NEVER MISUSE OR ABUSE A STABILIZER.

ASSEMBLY INSTRUCTIONS

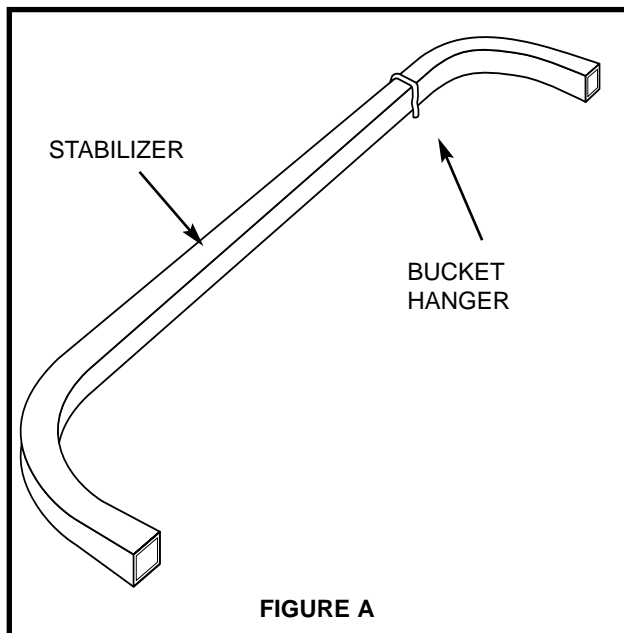

- 1 Slide bucket hanger onto stabilizer with hook of bucket hanger pointing in opposite direction of stabilizer legs. See Fig. "A".

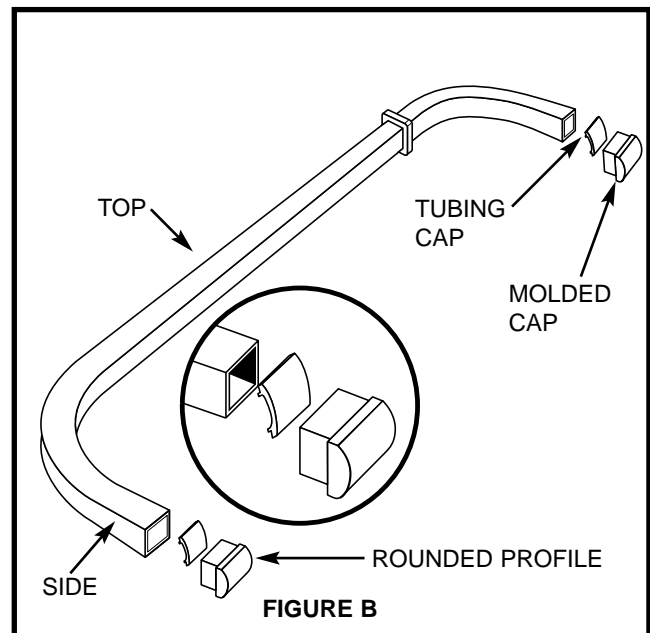

- 2 With tubing caps and molded caps oriented as shown in Fig. "B", push tubing cap into molded cap and then install both on the end of the stabilizer legs.

NOTE: If assembled properly rounded profile of caps should be on the side of the stabilizer.

USE INSTRUCTIONS FOR SINGLE SECTION AND EXTENSION LADDERS

READ ALL LABELS ON STABILIZER & INSTRUCTIONS WITH LADDERS

Attach the assembled unit at the upper most rung of ladder* as shown below.

* On a single ladder the upper most rung will simply be the top rung. On an extension ladder, it will be mounted on the top rung of the Fly Section of the ladder. The *Fly Section* can be identified by placing the feet on the ground and extending the ladder. The section that does the extending is the *Fly Section*.

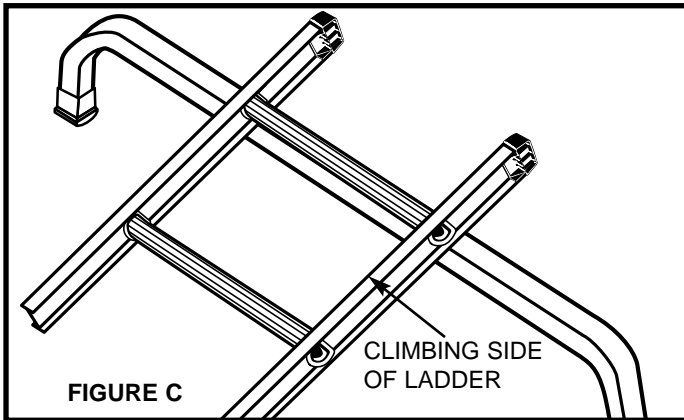

- 1 Position stabilizer on underside of ladder. See Fig. "C".

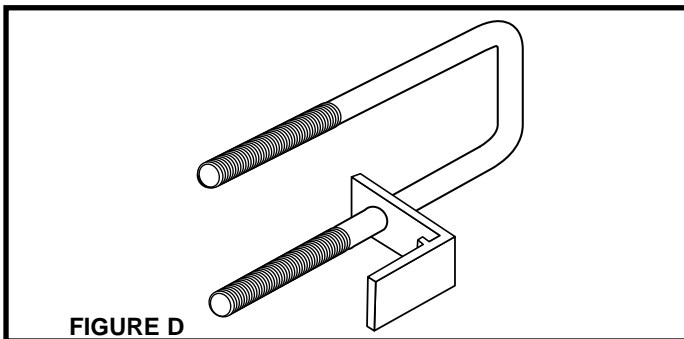

- 2 Place one leg of U-bolt through hole in angle clip as shown in Fig. "D".

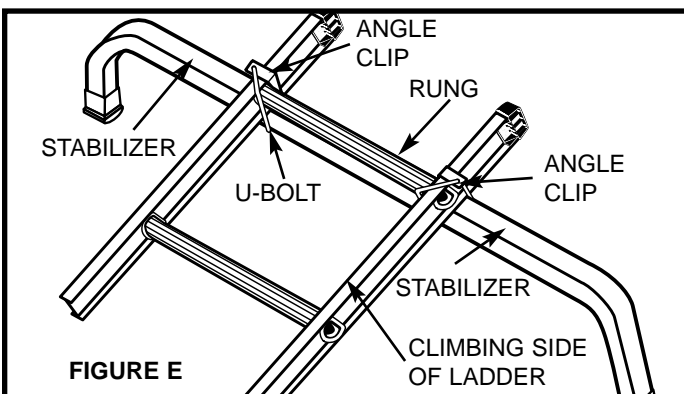

- 3 Place U-bolts diagonally across side rails with angle clips on outside leg as shown in Fig. "E".

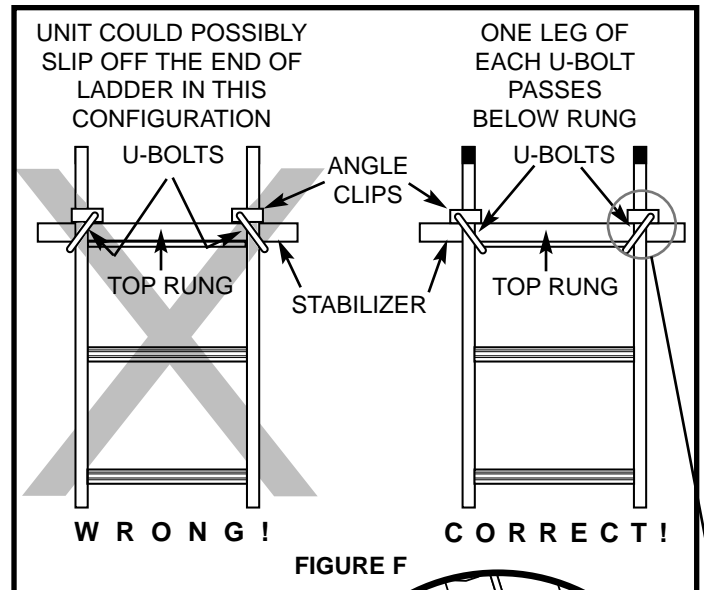

If assembled properly, angle clips will rest on top of rung and inside leg of U-bolt will be under rung as shown in Fig. "F". Proper orientation of U-bolts and angle clips will prevent stabilizer from sliding along the ladder.

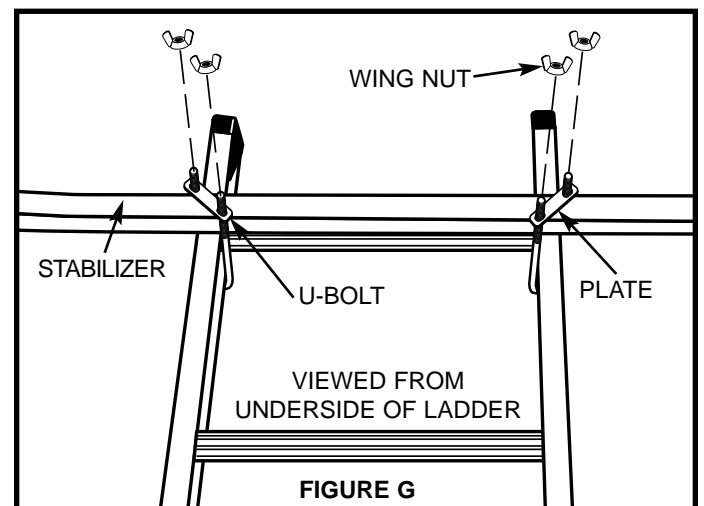
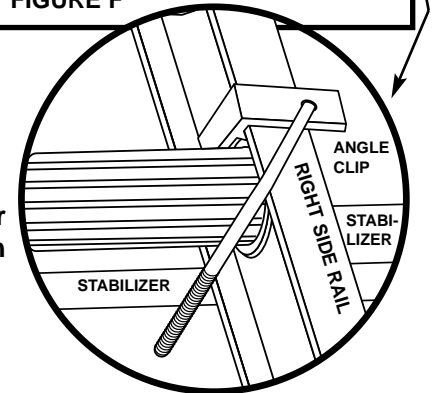

- 4 Install plate with U-bolt legs projecting thru slots in plates as shown in Fig. "G"
- 5 Install wing nuts and tighten securely. See Fig. "G".

USE INSTRUCTIONS FOR MT LADDER

READ ALL LABELS ON STABILIZER & INSTRUCTIONS WITH LADDERS

Attach assembled unit on either side of MT ladder at the uppermost rung when in extension ladder position. Placing stabilizer on underside of MT ladder while in extension ladder position will keep the ladder from closing completely, stabilizer will need to be removed. Stabilizer is shown on topside of MT ladder in illustrations.

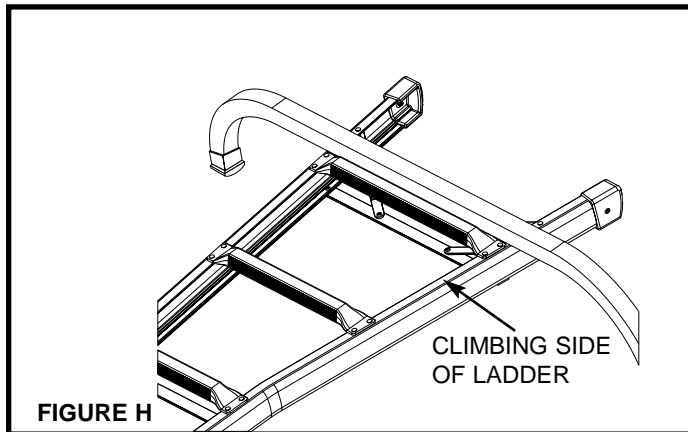

- 1 Position stabilizer at top rung. See Fig. "H" —shown on top side.

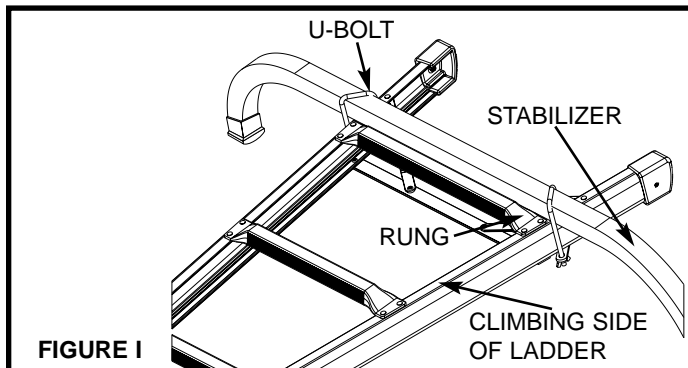

- 2 Place U-bolt diagonally across ladder side rails. U-bolt legs should point away from user, toward underside of ladder. (The angle clip is not used on MT ladders). See Fig. "I".

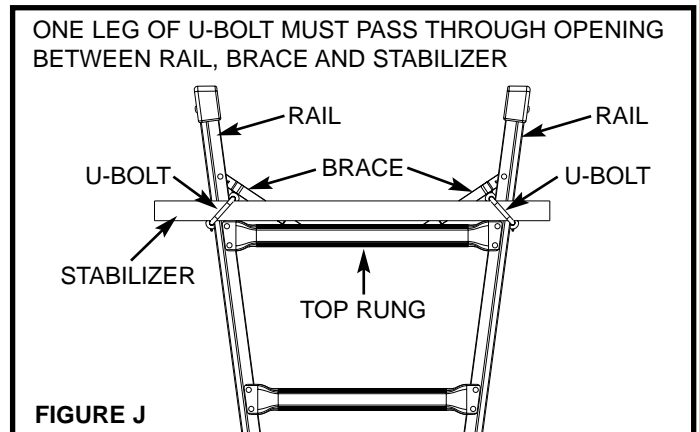

- 3 Place inside leg of U-bolt inside knee brace. See Fig. "J".

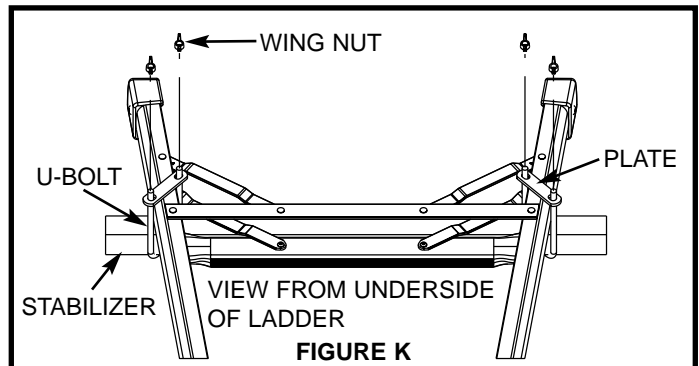

- 4 Install plates with U-bolt legs projected through slots in plates as shown in Fig. "K"
- 5 Tighten wing nuts securely. See Fig. "K".

IF YOU HAVE ANY QUESTIONS ON SAFE USAGE, ETC., CALL OR WRITE



WERNER CO., 93 WERNER ROAD, GREENVILLE, PA 16125-9499
PHONE (724) 588-8600